

## ► DESCRIPTIONS

The standard connector series. N is a widespread, medium size precision and waterproof threaded coupling. It is used, dependent on quality standard, up microwave.

Connectors are available for flexible, for semi-rigid and for corrugated copper tube cables.

## ► GENERAL

- MIL-C-39012



## ▶ INTERFACE DIMENSIONS

### PLUG

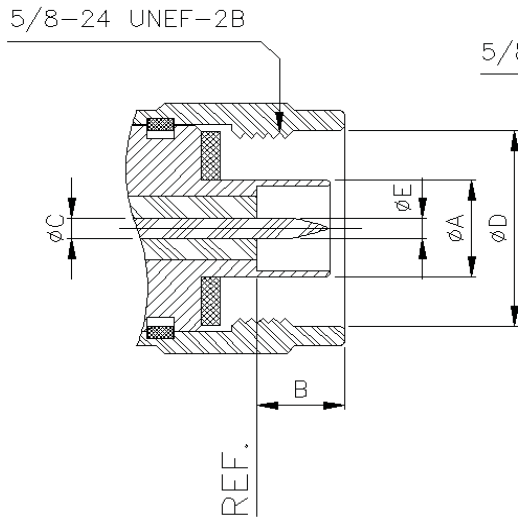

### JACK

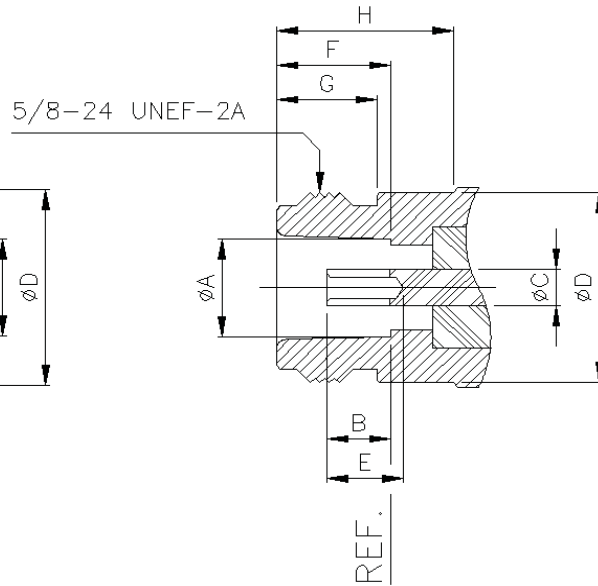

Rep.	PLUG				JACK			
	mm		inch		mm		inch	
	min.	max.	min.	max.	min.	max.	min.	max.
A		8.38		0.330	8.03	8.13	0.316	0.320
B	5.33	5.84	0.210	0.230	4.75	5.26	0.187	0.207
C		3.15		0.124		3.15		0.124
D	16.00		0.630			15.93		0.627
E	1.60	1.68	0.063	0.066	5.33		0.210	
F					9.04	9.19	0.356	0.362
G					6.76		0.266	
H					10.72		0.422	

## ► TECHNICAL DATA

REQUIREMENT	MIL-C-39012	SPECIFICATIONS
<b>Electrical Characteristics</b>		
Impedance		50 ohm                      75 ohm
Frequency range		11 GHz                      1.5 GHz
V.S.W.R	3-15	Straight                      1.30 max. Right angle                      1.50 max.
Dielectric withstanding voltage	3-17	Cable 5.0mm                      1500V/50Hz Cable 10.0mm                      2500V/50Hz
Insertion Loss	3-29	Straight                      0.15 dB max. at 10 GHz
Right angle		0.15 dB max. at 10 GHz
RF leakage	3-26	-90 dBm min.                      between 2 and 3GHz
Insulation resistance	3-11	5,000 Mohm min.
Contact resistance	3-16	Initial                      After Center contact                      1.0 mohm                      1.5 mohm Outer contact                      0.2 mohm                      -
Max. Contact current (DC)		10 A
Working voltage		1000V/50Hz, 700 V DC
Peak power	100MHz	5KW/500V
<b>Mechanical Characteristics</b>		
Proof torque		68 N-cm max.
Coupling nut retention force	3-27	453 N
Life time	3-15	500 matings
Cable retention force	3-24	Flexible cable 5mm                      40.5-180 N min. Flexible cable 10mm                      90-400 N min. Semi-rigid cable                      60-270 N min.
<b>Environmental Characteristics</b>		
Shock	3-19	MIL-STD-202(213)
Vibration	3-18	MIL-STD-202(204)
Moisture	3-21	MIL-STD-202(106)
Corrosion (salt spray)	3-13	MIL-STD-202(101)
Thermal shock	3-22	MIL-STD-202(107)
Temperature cycling	3-20	MIL-STD-202(102)
High temperature test		MIL-STD-202(108)
Operating temperature range	Standard	-65°C + 165°C
<b>Materials</b>		
Bodies	Brass	
Contacts(Female)	Beryllium copper	
Contacts(Male)	Brass	
Insulators	PTFE (Teflon)	
Gasket	Silicone rubber	
<b>Plating</b>		
Bodies		Nickel plated
Center contacts		Gold Plated

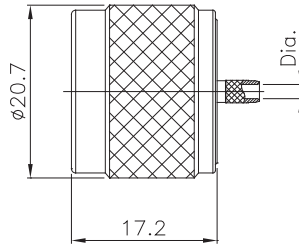

## Straight Plugs

### ■ Crimp Type

PART NO.	Dia.	CABLE
S580-627	Ø1.55(Ø1.7)	RG316(RG174)
S580-521	Ø3.1	RG 400, 58
REMARK	HEX. Coupling is possible	

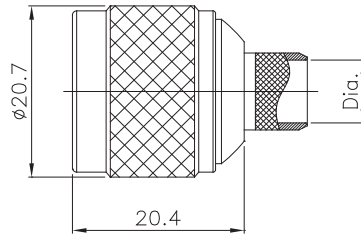

## Straight Plugs

### ■ Crimp Type

PART NO.	Dia.	CABLE
S580-380-C	Ø7.6	RG 213, 214 LMR 400
REMARK	HEX. Coupling is possible	

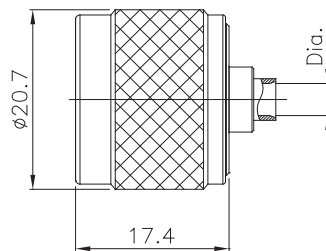

## Straight Plugs

### ■ Direct solder type

PART NO.	Dia.	CABLE
S580-465	Ø2.3	UT 085
S580-466-A	Ø3.7	UT 141
S580-461-A	Ø6.5	UT 250
REMARK	HEX. Coupling is possible	

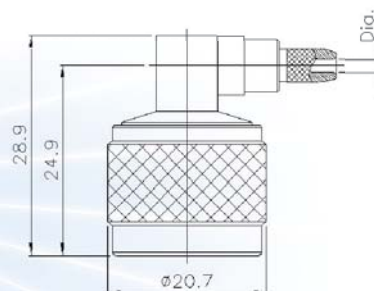

## Right Angle Plugs

### ■ Crimp Type

PART NO.	Dia.	CABLE
S580-2064	Ø1.55(Ø1.7)	RG 188, 316
S345-111-A	Ø3.1	RG 400, 58
REMARK	HEX. Coupling is possible	

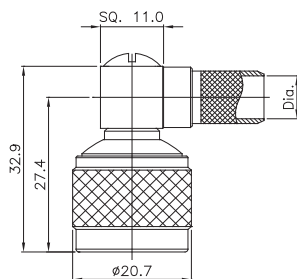

## Right Angle Plugs

### ■ Crimp Type

PART NO.	Dia.	CABLE
S580-380-C	$\phi 7.6$	RG 213 LMR 400
REMARK	HEX. Coupling is possible	

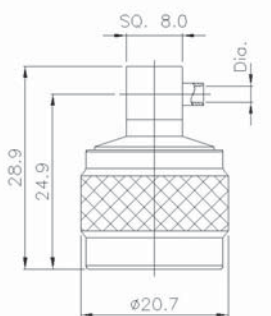

## Right Angle Plugs

### ■ Direct Solder type

PART NO.	Dia.	CABLE
S580-017	$\phi 2.3$	UT 085
S510-018	$\phi 3.7$	UT 141
REMARK	HEX. Coupling is possible	

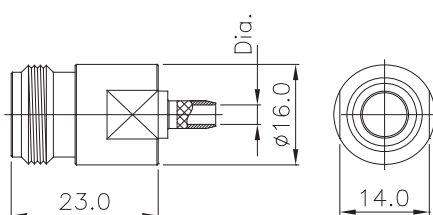

## Straight Jacks

### ■ Crimp Type

PART NO.	Dia.	CABLE
S580-053	$\phi 1.55(\phi 1.7)$	RG316(RG174)
S580-051	$\phi 3.1$	RG 400, 58
S580-408	$\phi 7.6$	RG 213, 214 LMR 400

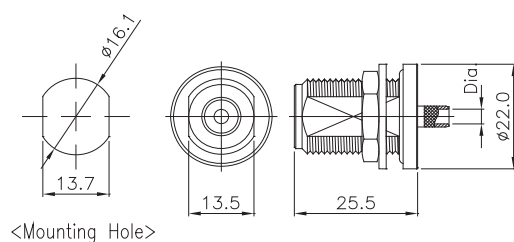

## Straight Bulkhead Jacks (Seal)

### ■ Crimp Type

PART NO.	Dia.	CABLE
S580-053	$\phi 1.55(\phi 1.7)$	RG316(RG174)
S580-051	$\phi 3.1$	RG 400, 58
S580-408	$\phi 7.6$	RG 213, 214 LMR 400

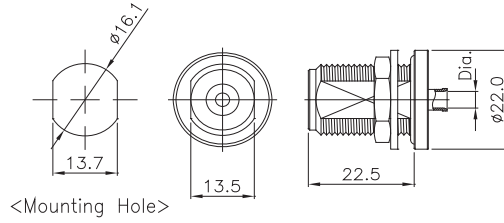

<Mounting Hole>

## Straight Bulkhead Jacks (Seal)

- Direct solder type

PART NO.	Dia.	CABLE
S580-729	Ø2.3	UT 085
S580-046	Ø3.7	UT 141
S580-048	Ø6.5	UT 250

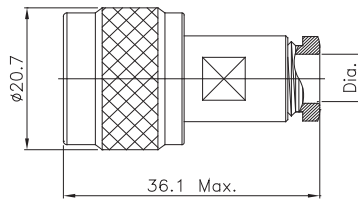

## Straight Plugs

- Clamp Type

PART NO.	Dia.	CABLE
S580-466-E	Ø5.5	RG 400, 58
S580-466-I	Ø6.5	LMR 240
S580-466-I	Ø10.9	RG 8, 214 LMR 400
REMARK	HEX. Coupling is possible	

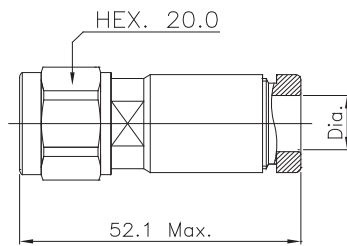

## Straight Plugs

- Clamp Type

PART NO.	Dia.	CABLE
S580-590	Ø10.9	RG 8, 213 LMR 400
REMARK	Water proof grade : IP 67	

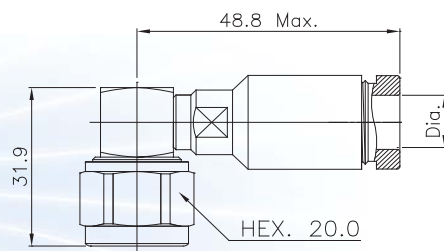

## Right Angle Plugs

- Clamp Type

PART NO.	Dia.	CABLE
S580-721	Ø10.9	RG 8, 213 LMR 400
REMARK	Water proof grade : IP 67	



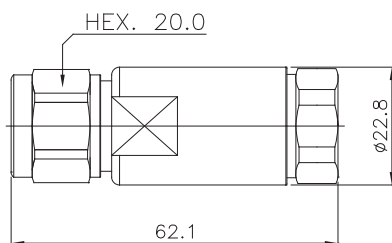

### Straight Plug

- Clamp Type

PART NO	CABLE
S580-294-01	1/2" Flexible

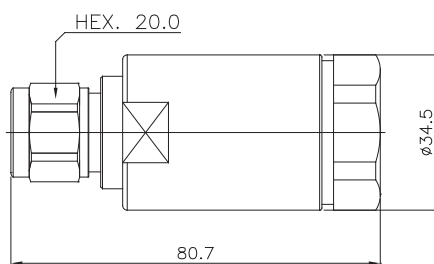

### Straight Plug

- Clamp Type

PART NO	CABLE
S580-312-01	7/8" Flexible

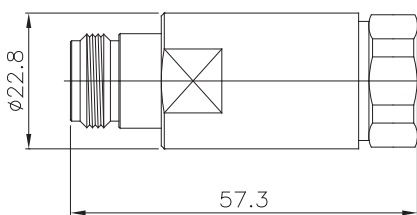

### Straight Jack

- Clamp Type

PART NO	CABLE
S580-292-01	1/2" Flexible

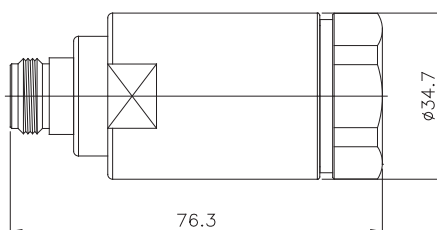

### Straight Jack

- Clamp Type

PART NO	CABLE
S580-294-01	7/8" Flexible

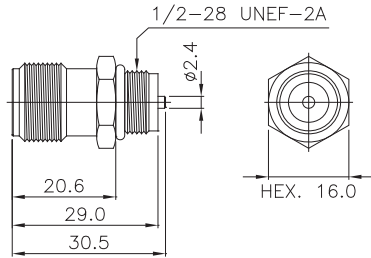

## Straight Bulkhead Jack

- Front mount type

PART NO	IMPED
S580-164	50 Ω

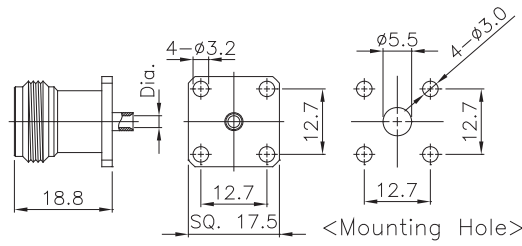

## Straight 4Hole Flange Jack

- Direct Solder type
- Panel mount

PART NO.	Dia.	CABLE
S580-450	Ø2.3	UT-085
S580-450-I	Ø3.7	UT-141

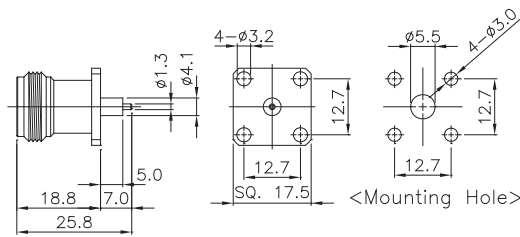

## Straight 4Hole Flange Jack

- Panel mount

PART NO	IMPED
S580-118	50 Ω

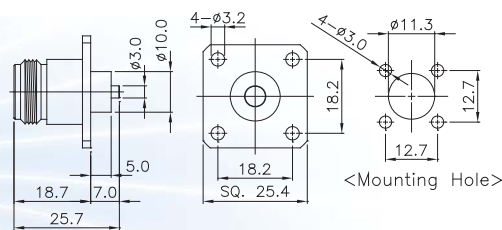

## Straight 4Hole Flange Jack

- Panel mount

PART NO	IMPED
S580-538	50 Ω



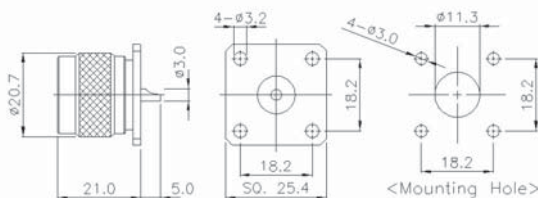

## Straight 4 Hole Flange Plug

- Panel mount

PART NO	IMPED
S580-116	50 $\Omega$

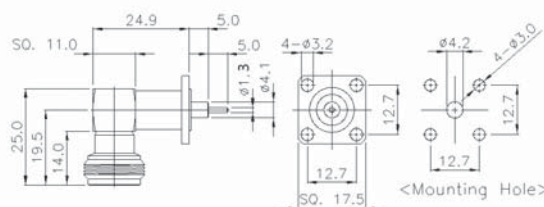

## Right Angle 4H Flange Jack

- Panel mount

PART NO	IMPED
S580-617	50 $\Omega$

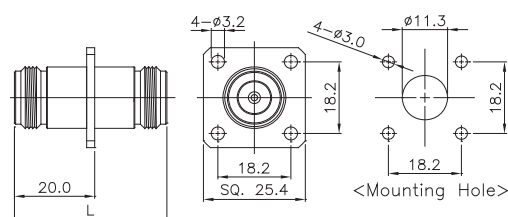

## Jack To Jack 4 Hole Flange Adaptor

- Panel mount

PART NO	L
S580-203	38.0mm
S580-711-A	68.0mm

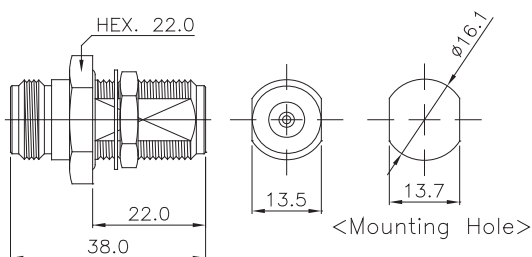

## Jack To Jack Bulkhead Adaptor

- Panel mount

PART NO	IMPED
S580-207	50 $\Omega$

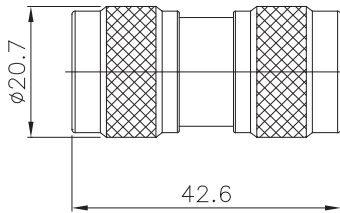

### Plug To Plug Adaptor

PART NO.	IMPED
S345-701	50 Ω
REMARK	HEX. Coupling is possible

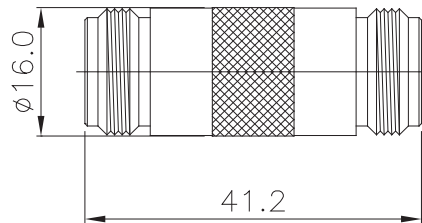

### Jack To Jack Adaptor

PART NO.	IMPED
S580-202	50 Ω

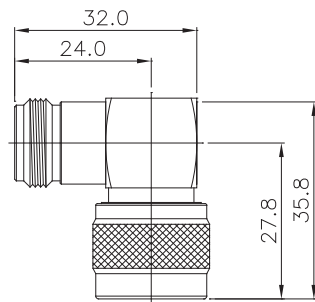

### Plug To Jack Right Angle Adaptor

PART NO.	IMPED
S580-478-E	50 Ω
REMARK	HEX. Coupling is possible

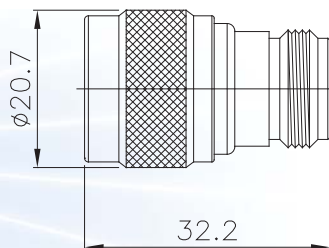

### Plug To Jack Adaptor

PART NO.	IMPED
S580-206	50 Ω
REMARK	HEX. Coupling is possible

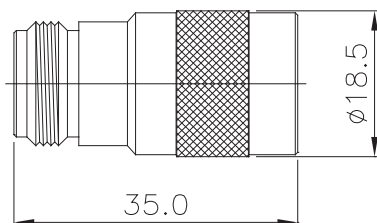

### Plug To Jack Push-on Adaptor

- Quick Connect Type

PART NO.	IMPED
S580-234	50 Ω

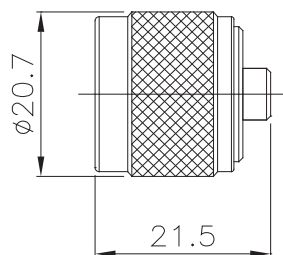

### Plug Termination

PART NO.	IMPED
S580-924-E	50 Ω, 1W
S580-914-F	50 Ω, 2W

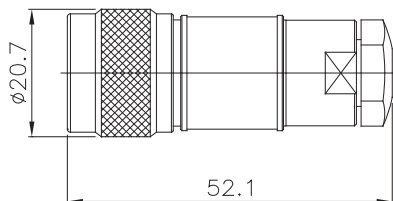

### Plug Termination

- DC Block Type

PART NO.	IMPED
S630-204	50 Ω

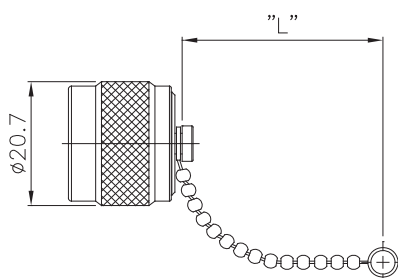

### Male Dust Cap

- Bead Chain Type

PART NO.	L
S345-853	70mm ~ 150mm